

PROPOSED PLAN FOR (G + III) STORED RESIDENTIAL BUILDING OF B.L.SURYADITYA-1 AT MOUZA - DHALUA, J.L NO. 43, PART OF R.S. DAG NO. 237, R.S. KHATIAN - NOS. 25 & 220, L.R. DAG NO. 248, L.R. KHATIAN NO.4152, WARD NO.2, HOLDING NO. 2152, P.S. SONARPUR, DIST. 24 PARGANAS (SOUTH), UNDER RAJPUR SONARPUR MUNICIPALITY.

LOCATION MAP
22°28'14.0" N
88°24'23.9" E

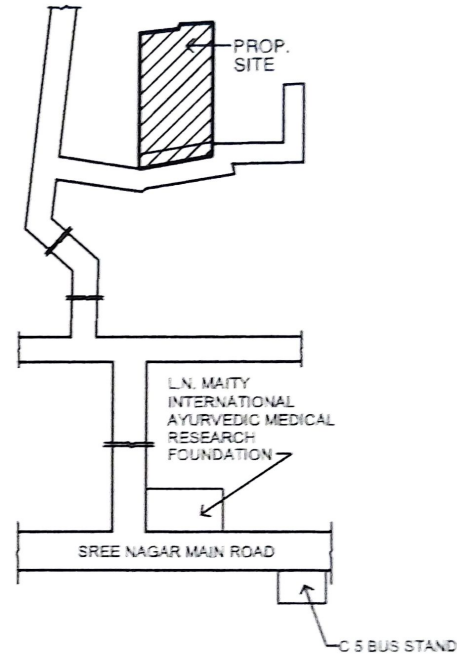

B. L. REALTY (INDIA) PVT. LTD.
Madhusudan Pramanik
Managing Director

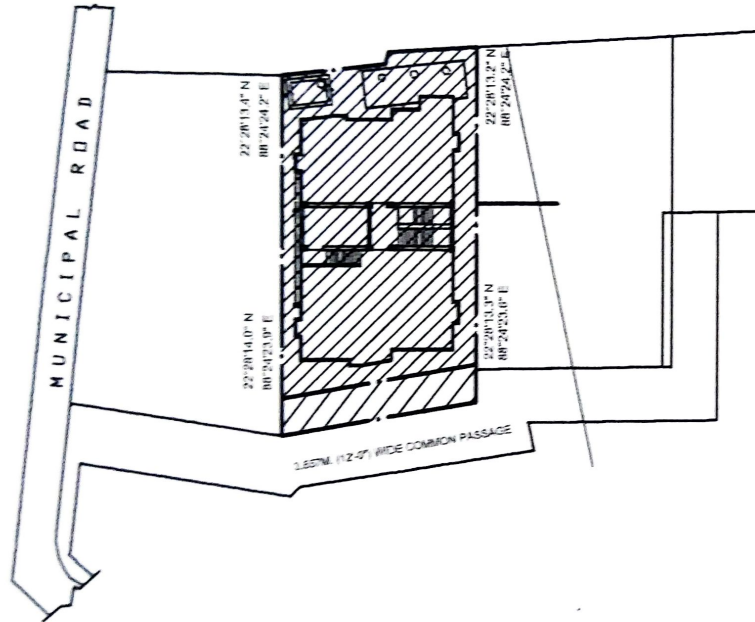